

# THE NOTARY HOTEL

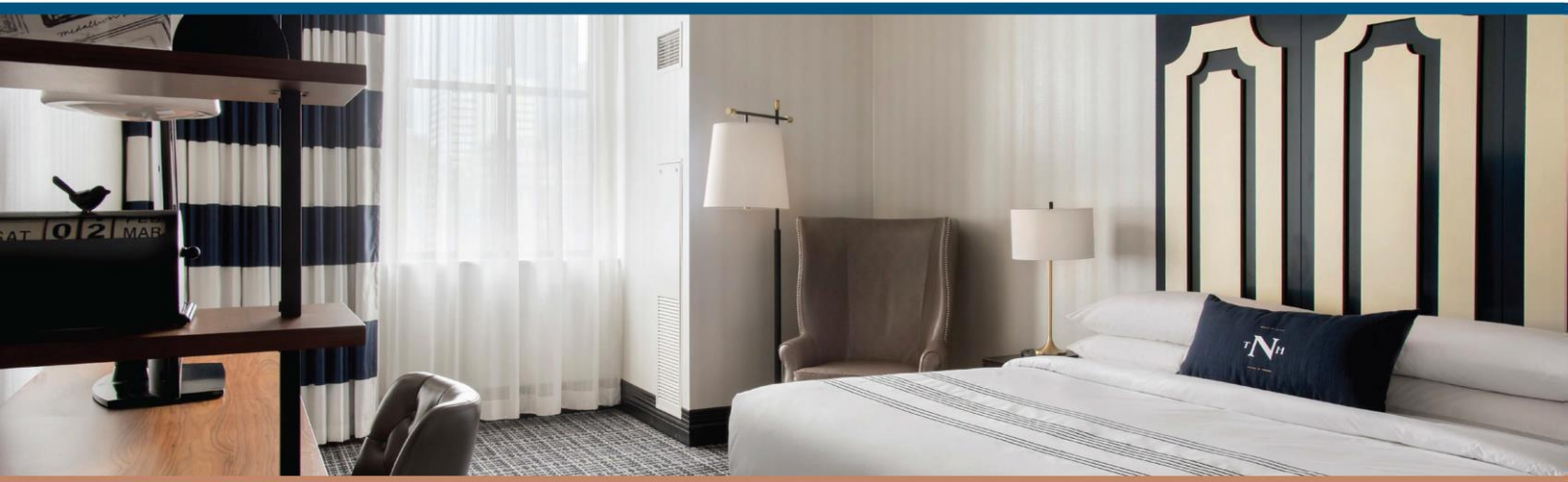

## HISTORY REBORN

In Center City Philadelphia, the former City Hall Annex is reborn as The Notary Hotel. Where once beat the heart of city government now stands an iconic destination with historic, classical architecture. The Notary offers a luxurious hospitality experience rich with notable moments and the ideal environment for large conferences, events and weddings. Whether you're enjoying a craft cocktail and dinner at our tapas restaurant Sabroso+Sorbo, or lounging in one of our decadent guest rooms, indulge in the signature melange of history and comfort that makes The Notary truly exceptional.

## LOCATION

Connect to the culture, spirit and history of modern Philadelphia from our central, Penn Square hotel. Set in Center City, close to the finest restaurants, museums, retail and entertainment destinations, we offer the ideal location from which to journey out and experience our dynamic city.

### ATTRACTIONS

- Pennsylvania Convention Center
- Reading Terminal Market
- Independence Hall & Liberty Bell
- Independence Visitors Center
- Philadelphia Museum Of Art
- City Hall
- National Constitution Center
- Philadelphia Zoo
- Kimmel Center For Performing Arts
- Citizens Bank Park
- Lincoln Financial Field

## DINING

- Sabroso+Sorbo is an all-day restaurant and bar serving Spanish-inspired fare in a warm, buzzy atmosphere. From breakfast to early evening drinks and small plates to long dinners with friends, there's always a good reason to stop by, sip, and savor the moment.
- Hotel Coffee Bar serving La Colombe coffee & fresh, local pastries.

## SERVICES & AMENITIES

- Retail Area
- Sabroso+Sorbo Restaurant & Bar
- Serving Breakfast & Dinner
- Room Service Available from 5pm-10pm
- Fitness Center
- Valet Parking

## ROOM FEATURES

- Wireless Internet Services
- 55" Smart TV With HD
- Refrigerator
- Luxury Bedding
- In-Room Safe
- In-Room Coffee Maker

# THE NOTARY HOTEL

MEETING ROOM	DIMENSIONS (W X L X H)	SQUARE FEET	THEATER (MAX)	SCHOOLROOM (MAX)	CONFERENCE (MAX)	U-SHAPE (MAX)	RECEPTION (MAX)	BANQUET (MAX)
Grand Ballroom	92' x 32' x 14'	2,944	250	120	40	34	250	210
Salon I	16' x 31' x 14'	496	40	20	22	20	35	30
Salon II	37' x 31' x 14'	1,147	150	75	32	28	100	90
Salon III	22' x 31' x 14'	682	60	32	26	22	60	50
Salon IV	17' x 31' x 14'	527	40	20	22	20	35	30
Salon I & II	53' x 31' x 14'	1,643	170	75	32	28	135	120
Salon III & IV	39' x 31' x 14'	1,209	70	36	N/A	22	95	80
Salon II & III	59' x 31' x 14'	1,767	220	120	40	34	160	150
William Penn Boardroom	12' X 22' X 14'	265	N/A	N/A	10	N/A	N/A	N/A
Logan	20' x 34' x 14'	680	49	32	26	24	49	40
Rittenhouse	20' x 34' x 14'	680	49	32	26	24	49	40
Washington	20' x 31' x 14'	620	43	29	24	22	43	40
Junipers Ballroom	37' x 92' x 15'	3,404	320	175	60	54	300	250
Mezzanine Foyer	-		N/A	N/A	N/A	N/A	180	100
Mezzanine 1	14' x 34' x 14'	476	N/A	N/A	18	N/A	N/A	N/A
Mezzanine 2	18' x 26' x 12'	468	30	20	18	16	30	30
Philip H Johnson Library	15.5' x 37' x 15'	574	N/A	N/A	20	N/A	40	30

## MEETING & EVENT SPACES

Our event spaces offer an exceptional backdrop for large conferences, private events, and weddings. Crafted for comfort, flexibility and productivity, we offer a variety of spaces for any group's needs. Our seasoned event management team is committed to bringing your vision to life.

- 12 Meeting Rooms With 11,000 sq. ft. of Meeting Space
- Natural Light In All Meeting Rooms
- Full Service Catering And Events Team
- Full Service Audio Visual Team



## LOBBY LEVEL



## MEZZANINE LEVEL

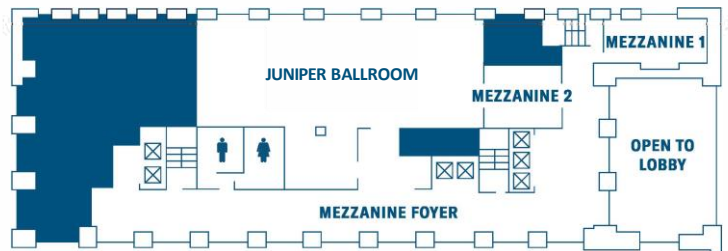

## FIRST FLOOR

